

top
scale 1:4

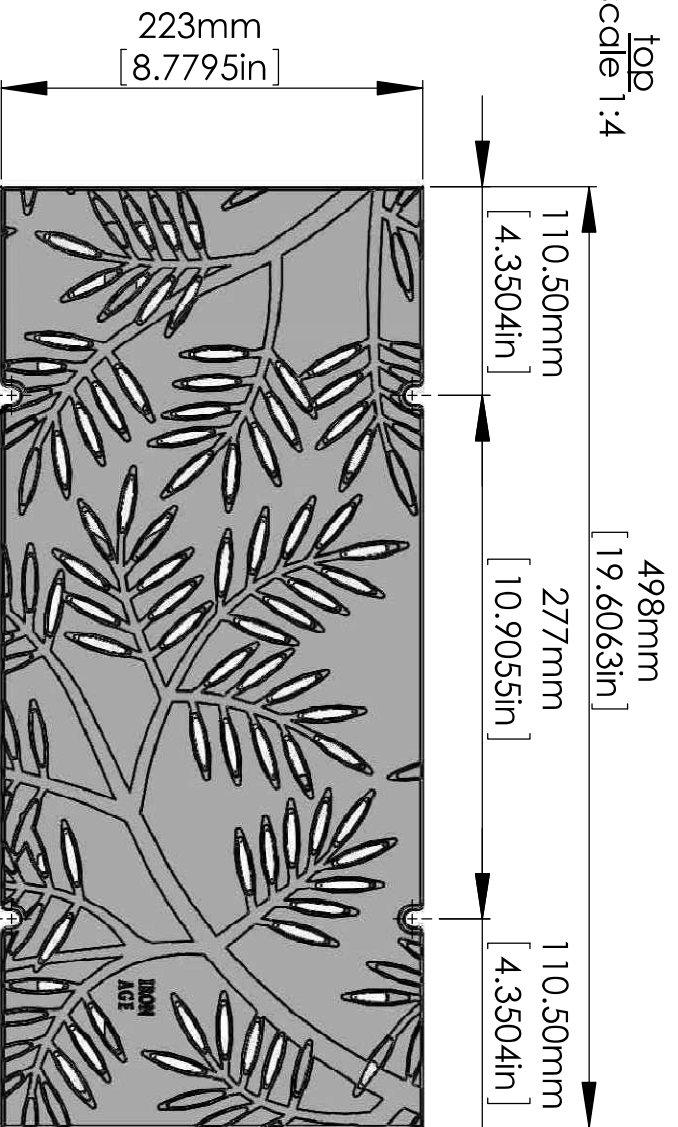

end
scale 1:4

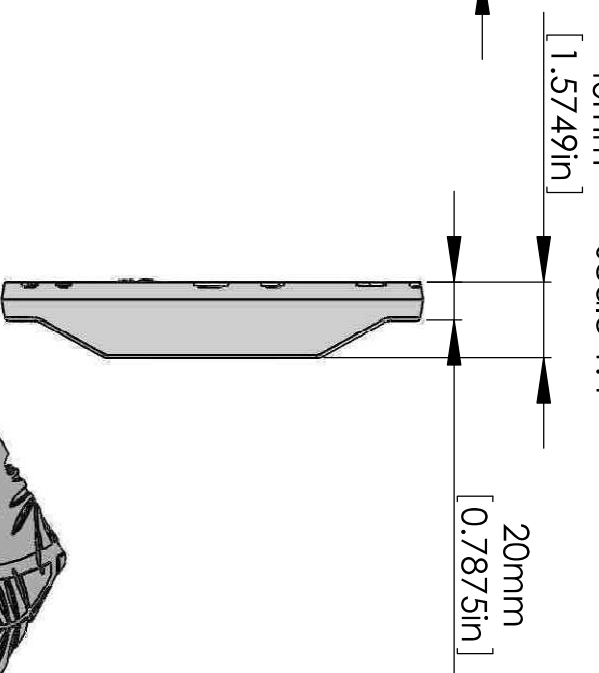

edge
scale 1:4

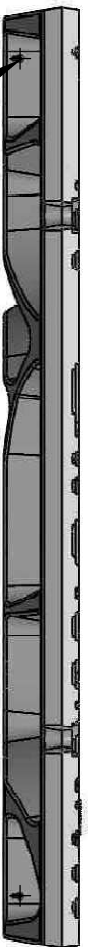

(4X) drill point to locate hole for PROFIX™

perspective
scale 1:6

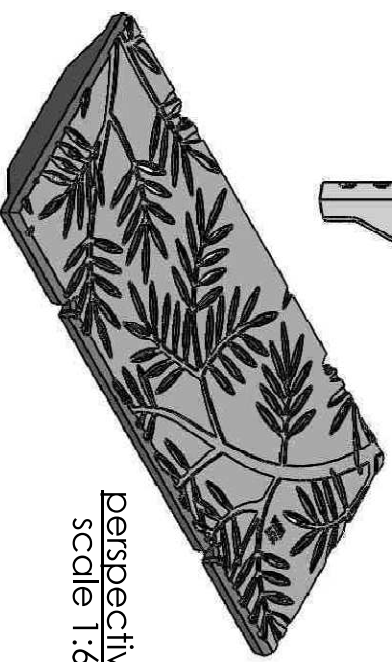

rear
scale 1:8

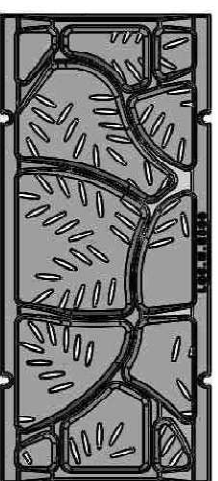

IRON AGE
DESIGNS

2104 SW 152nd St. #4 TEL 206.276.0925
Burien, WA 98166 FAX 206.257.0318
www.ironagedesigns.com

Locust 9" X20" Heel-Proof

Trench Grate

DWG. NO. LOC.M.E600

Drawn by: CD

Date: 01/05/06

Scale: NTS

NOTES:

1. Material: cast ductile iron
2. Finish: Natural
3. Edge Thickness: 20mm/0.79"
4. Replaces drain manufactured by: MEA® EN2000
5. No openings greater than: 6mm / 1/4" – Heel-Proof
6. Approximate weight 10.4 Kg (24.2 lbs)
7. Due to casting inconsistencies all dimensions are nominal

© 2006 Iron Age Designs

Registration Number:
VA-1-814-274